

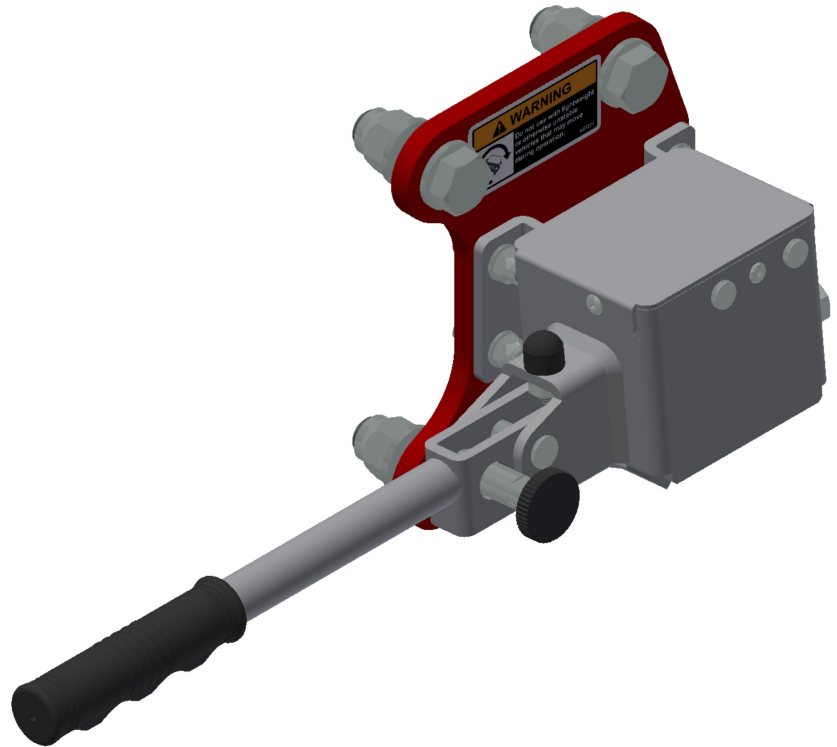

Read these instructions thoroughly before operating the equipment. Keep it with the equipment at all times. Replacements are available from Thern, Inc., Winona, MN 55987, 507-454-2996. www.thern.com

ORIGINAL TEXT



Supplemental Instructions

For 3CP1H-HM Capstan Hitch Mount

These instructions are to serve as guidelines for hazard-free installation, operation, and maintenance. They should not be understood to prepare you for every possible situation.

Suggestions for Safe Operation

Keep these instructions readable and with the equipment at all times. Contact Thern, Inc. for replacements.

Keep all unnecessary personnel away while in operation.

Do not exceed the load rating of the capstan or any other component in the system. To do so could result in failure of the equipment.

Do not use damaged or malfunctioning equipment. To do so could result in failure of the equipment.

Do not modify the equipment in any way. To do so could cause equipment failure.

Align the vehicle and winch with the operation to maintain proper rope fleet angle to the winch drum.

Do not use the hitch mount accessories with lightweight or otherwise unstable vehicles that may move during operation.

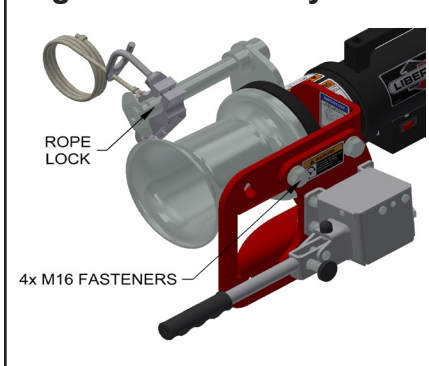
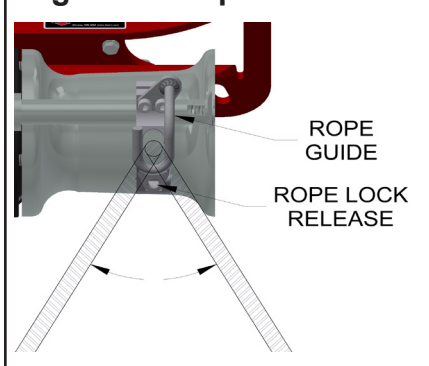
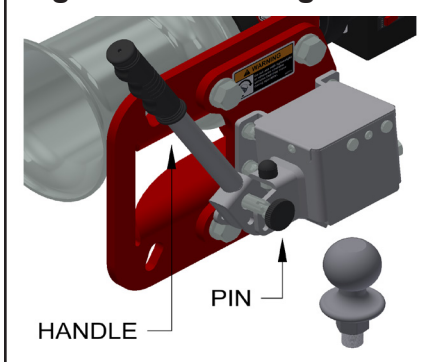
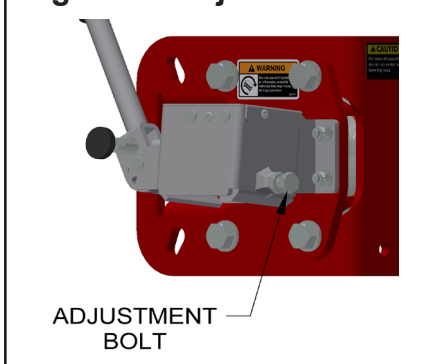

Figure 1 - Assembly**Figure 2 - Rope Guide****Figure 3 - Installing****Figure 4 - Adjustment**

1.1 Assembling the Capstan

- 1.1.1 STUDY PARTS DRAWINGS to understand how the hitch mount adapter is assembled. **See page 3.**
- 1.1.2 MOUNT THE CAPSTAN to the hitch mount adapter using the four supplied fasteners. Tighten the M16x50mm grade 8.8 fasteners to 137 ft-lbs. (185 Nm). **See Figure 1.**
- 1.1.3 ROTATE THE ROPE LOCK as needed to allow proper operation and rope take-off position. You may need to remove and reconfigure the rope lock mounting bar for correct orientation. **See Figure 1.**
- 1.1.4 ROPE GUIDE may be installed and used as needed to allow various hand line rope exit angles while maintaining proper fleet angle to the drum. This may help position the operator in the desired location. **See Figure 2.**
 - a. ROPE LOCK RELEASE cord should be routed through the hole beneath hand line to also allow various angles for release cord.

1.2 Installing the Capstan

⚠WARNING

Attach the winch only to structurally sound locations capable of supporting the equipment and all reaction loads. **WORKING LOAD LIMIT: 1000 lbs. (450 kg)**

Attach only to a 2 inch (50 mm) hitch ball.

- 1.2.1 INSTALLING ON A HITCH BALL.
 - a. PULL PIN AT QUICK-CONNECTOR to allow handle to pivot. This allows the clamp to open and fit over the hitch ball. **Make sure the hitch ball is undamaged, clean, and free of grease. See Figure 3.**
 - b. CLOSE THE HANDLE and latch pin into place to prevent the quick-connector clamp from opening unintentionally.
 - c. USE THE CLAMP ADJUSTMENT BOLT as necessary for a tight fit on the hitch ball. **See Figure 4.**
- 1.2.2 ALIGN THE VEHICLE with the lifting operation.
 - a. POSITION THE WINCH to maintain proper rope fleet angle with the drum and to avoid twisting on the hitch ball.
 - b. USE RIGGING AS NECESSARY, such as a heel block, so the rope under tension exits straight and level behind the vehicle. Other rope exit angles are possible but will result in additional loads on the hitch ball and vehicle.
 - c. CHOCK THE VEHICLE WHEELS to prevent movement during operation.

1.3 Inspecting the Equipment

Do not use damaged or malfunctioning equipment. Place an “OUT OF ORDER” sign on the equipment. Do not use the equipment until the sign is removed by a qualified person who has completely corrected the problem.

1.3.1 INSPECT THE EQUIPMENT before each use to detect signs of damage or poor operation before they become hazardous.

- Check all equipment for cracks, dents, bending, rust, wear, corrosion, and other damage.
- Make sure all fasteners are tight and secure.

Model 3CP1H-HM

item	description	part number	qty.
1	CONNECTOR QUICK-RELEASE 50MM BALL	A37717	1
2	PLATE ADPATER 3CP1H	A37718	1
3	WASHER FLT 16 X 30MM X 3MM ZNPL	A9629	8
4	NUT HEX NYLK M16-2.0 ZNPL CL8	A12152	4
5	CAPSCR HEXHD M16-2.0 X 50MM ZNPL 8.8	A7830	4
6	WASHER FLT M8 X 16MM X 1.6MM ZNPL	A10676	8
7	NUT HEX NYLK M8-1.25 ZNPL CL8	A10080	4
8	CAPSCR HEXHD M8-1.25 X 30MM ZNPL 8.8	A7506	4
9	LABEL WARNING VEHICLE STABILITY	A27271	1

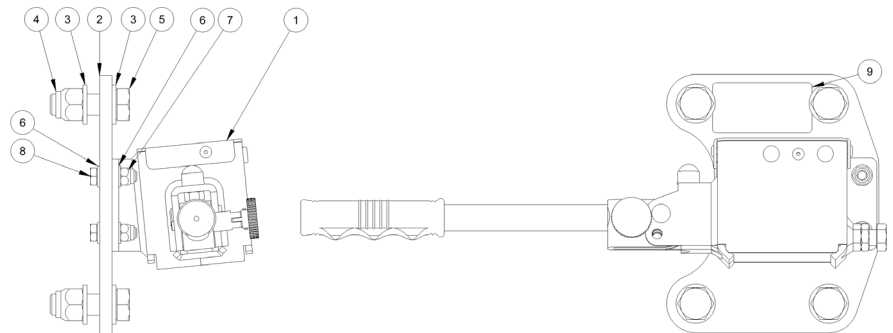

Model 3CP-RG

item	description	part number	qty.
1	CAPSTAN ROPE GUIDE	A37680	1
2	CAPSCR SOKHD M8-1.25 X 40MM SST A2	A37622	2

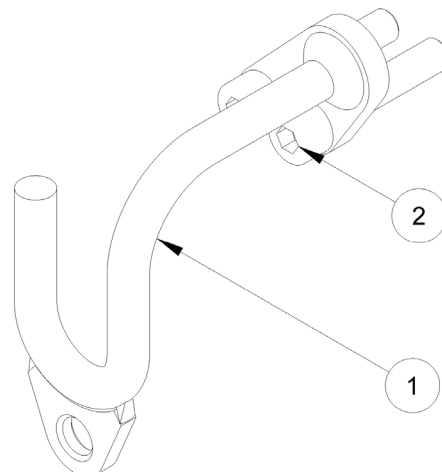



Thern, Incorporated
5712 Industrial Park Road
Winona, MN 55987

Toll Free: 1-800-843-7648
Phone: 1-507-454-2996

Email: info@thern.com
www.thern.com

Thern Europe
Siriusdreef 17-27,
2132 WT Hoofddorp
The Netherlands

Phone: +31-546-898380
Email: europe@thern.com